

ITEM NO.	PART NUMBER	PROCESS	MATERIAL	FINISH	QTY.
1	RWA-160106-G1-REV-G1-(Roswell Medallion)	Die Cast	6061 Alloy	Chrome plated	1
2	RWA-120906-E1-REV-G9-(Right Tine)	See Sub Assembly	See Sub Assembly	See Sub Assembly	1
3	FLH-SCH-82_~250-20 UNC_1_SIMP	STOCK ITEM	Stainless Steel	RAW	4
4	COB-201205-G7-REV-G0-(Custom Locking Pin)	STOCK ITEM	Stainless Steel	RAW	2
5	SSCR-HEX-CUP_~190-24 UNC_0~375_HELI	STOCK ITEM	Stainless Steel	RAW	2
6	SCH_~250-20 UNC_0~75_SIMP	STOCK ITEM	Stainless Steel	RAW	4
7	RWA-201205-G5-REV-E2-(SI Caddy Backing Plate)	Die Cast/CNC Machined	6061 Alloy	Highly Polished	1
8	RWA-120906-E1-REV-G8-(Left Tine)	See Sub Assembly	See Sub Assembly	See Sub Assembly	1

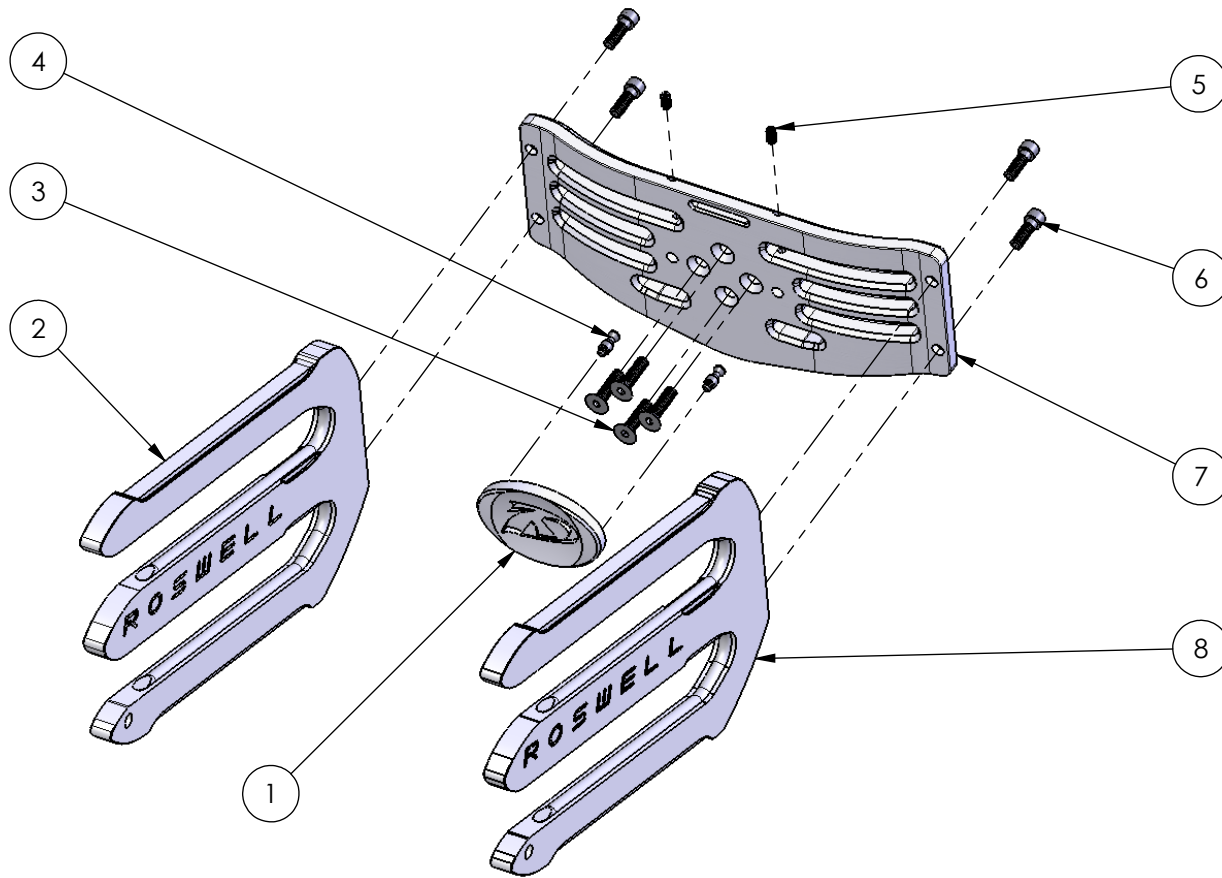

REVISION NOTES:

**PROPRIETARY AND CONFIDENTIAL**  
 THE INFORMATION CONTAINED IN THIS DRAWING IS THE SOLE PROPERTY OF ROSWELL WAKE AIR. ANY REPRODUCTION IN PART OR AS A WHOLE WITHOUT THE WRITTEN PERMISSION OF ROSWELL WAKE AIR IS PROHIBITED.

DRAWN BY:	egagnon	MATERIAL:	SEE BOM TABLE
PROCESS:	SEE BOM TABLE	FINISH:	SEE BOM TABLE
DO NOT SCALE DRAWING			

UNLESS OTHERWISE SPECIFIED:  
 DIMENSIONS ARE IN INCHES  
 TOLERANCES:  
 DECIMAL: x. ± 0.06  
 x.x ± 0.03  
 x.xx ± 0.015  
 x.xxx ± 0.005  
 FRACTIONAL: xx x/x ± 1/16"  
 x x/x ± 1/32"  
 x/x ± 1/64"  
 ANGULAR: ±0.5°



RWA-201205-G6-REV-E1-(SI Caddy Rack Assembly BOM)

BRAND-DATE-DESIGNER-REVISION-(Description)

SCALE: 1:4 REVISION DATE: Tuesday, December 11, 2007